

TITLE.

Copeland Road Car Park, SE15. APPROPRIATION EXTENT



DRAWING No. LBS_3221(Layout2)

DRAWN BY. MMANKTELOW
Property Division

DATE. 2/2/2017

Reproduced from the Ordnance Survey mapping with the permission of the Controller of Her Majesty's Stationery Office © Crown copyright. Unauthorised reproduction infringes Crown copyright and may lead to prosecution or civil proceedings. (London Borough of Southwark / Licence No. LA086541).

Original Scale - 1:1250

Subject to variation when reproduced from an Adobe pdf source

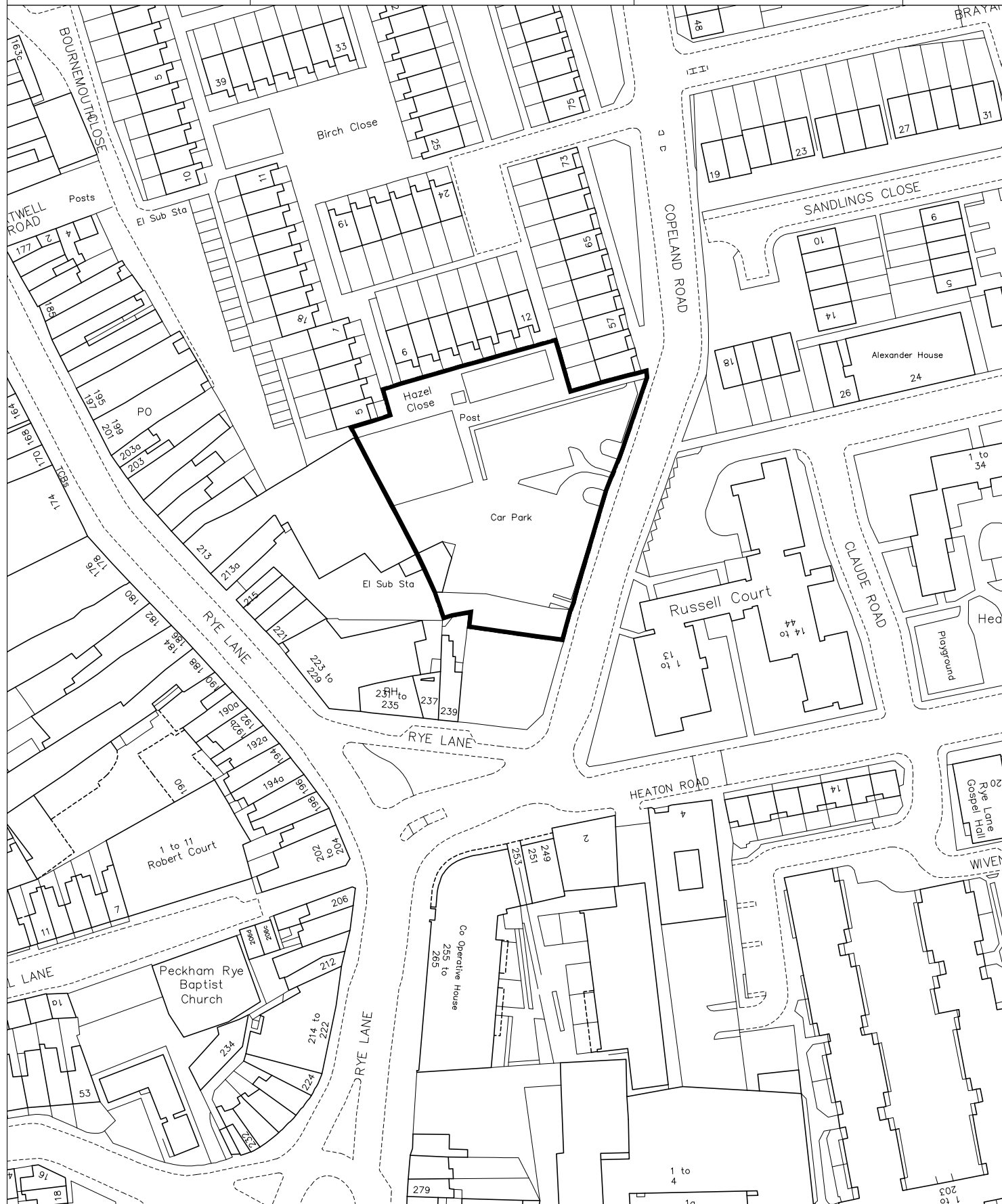

TITLE.

Peckham Library Square, SE15.

APPROPRIATION EXTENT



DRAWING No. LBS_3404(Layout2)

DRAWN BY. MMANKTELOW
Property Division

DATE. 18/1/2017

Reproduced from the Ordnance Survey mapping with the permission of the Controller of Her Majesty's Stationery Office © Crown copyright. Unauthorised reproduction infringes Crown copyright and may lead to prosecution or civil proceedings. (London Borough of Southwark / Licence No. LA086541).

Original Scale - 1:1250

Subject to variation when reproduced from an Adobe pdf source





TITLE.

Petrol Station,
Old Kent Road, SE1.

APPENDIX 3

APPROPRIATION EXTENT

DRAWING No. LBS_3220(Layout2)

DRAWN BY. MMANKTELOW
Property Division

DATE. 18/1/2017

Reproduced from the Ordnance Survey mapping with the permission of the Controller of Her Majesty's Stationery Office © Crown copyright. Unauthorised reproduction infringes Crown copyright and may lead to prosecution or civil proceedings. (London Borough of Southwark / Licence No. LA086541).

Original Scale - 1:1250

Subject to variation when reproduced
from an Adobe pdf source

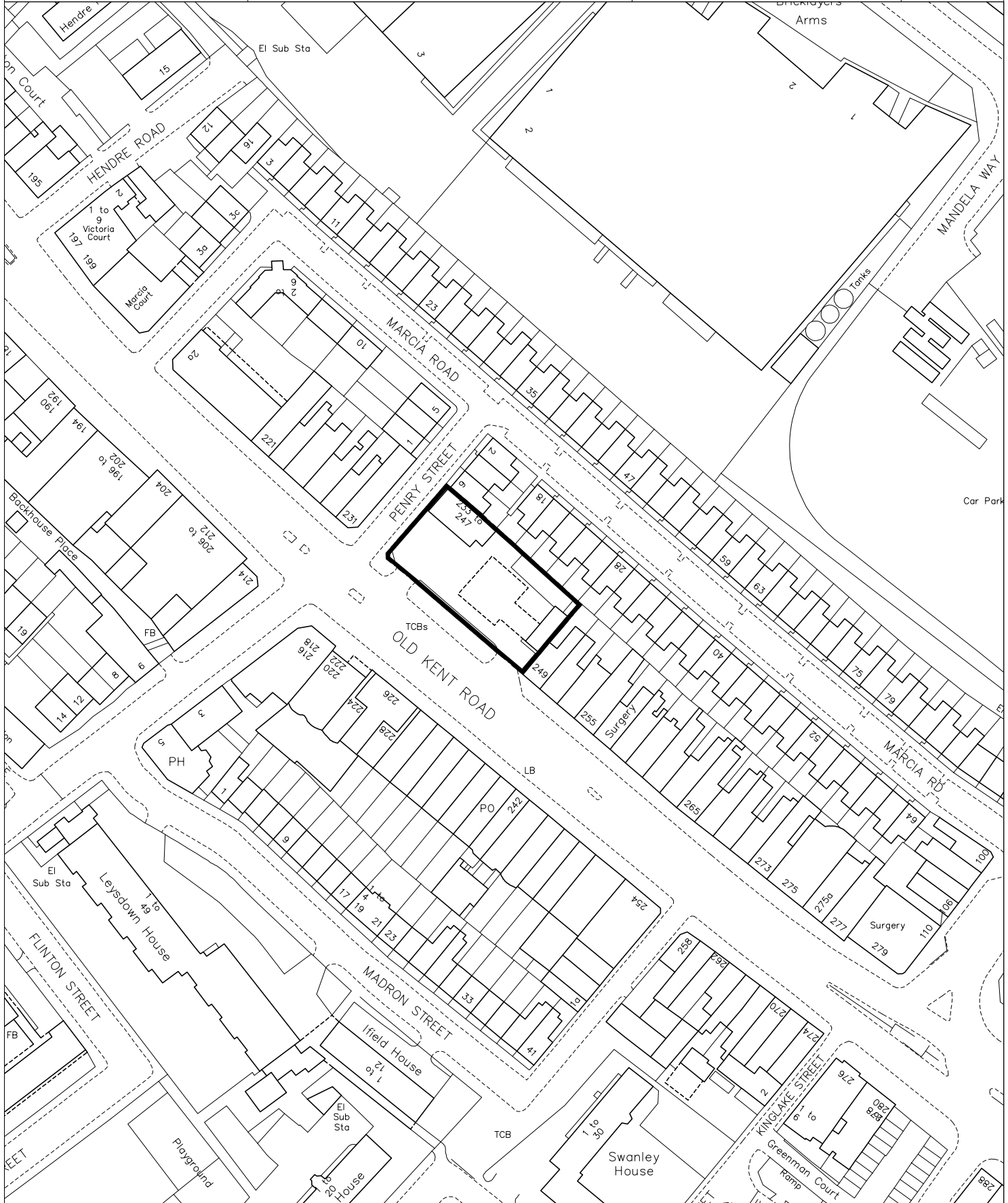

TITLE.

Flaxyards.



DRAWING No. LBS_3247(Layout2)

DRAWN BY. MMANKTELOW
Property Division

DATE. 8/3/2017

Reproduced from the Ordnance Survey mapping with the permission of the Controller of Her Majesty's Stationary Office © Crown copyright. Unauthorised reproduction infringes Crown copyright and may lead to prosecution or civil proceedings (London Borough of Southwark / Licence No. LA086541).

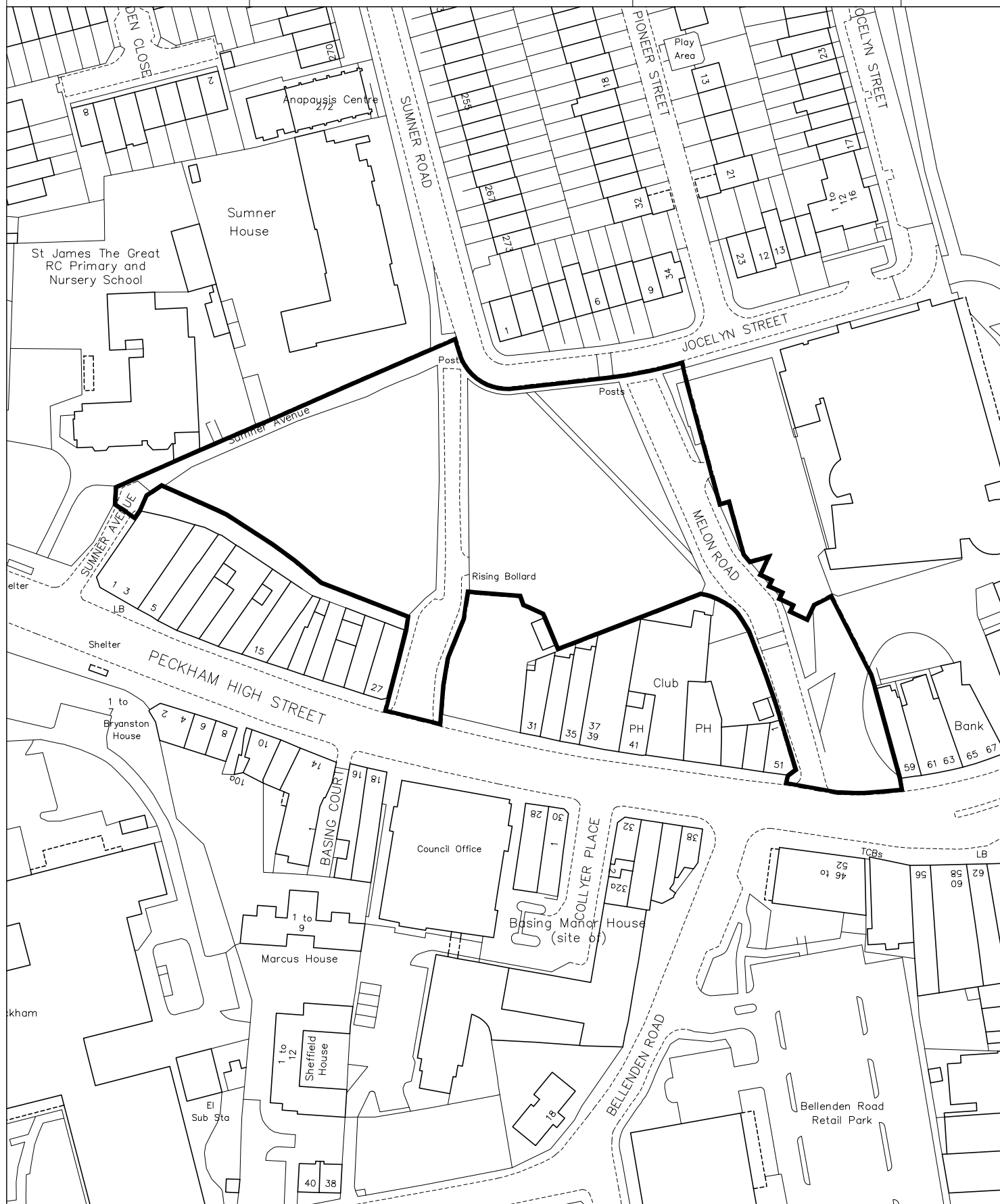
Original Scale - 1:1250Subject to variation when reproduced
from an Adobe pdf source

TITLE.

Parkhouse Street, SE5 7TQ.

APPROPRIATION EXTENT



DRAWING No. LBS_3548(Layout2)

DRAWN BY. MMANKTELOW
Property Division

DATE. 7/2/2017

Reproduced from the Ordnance Survey mapping with the permission of the Controller of Her Majesty's Stationery Office © Crown copyright. Unauthorised reproduction infringes Crown copyright and may lead to prosecution or civil proceedings. (London Borough of Southwark / Licence No. LA086541).

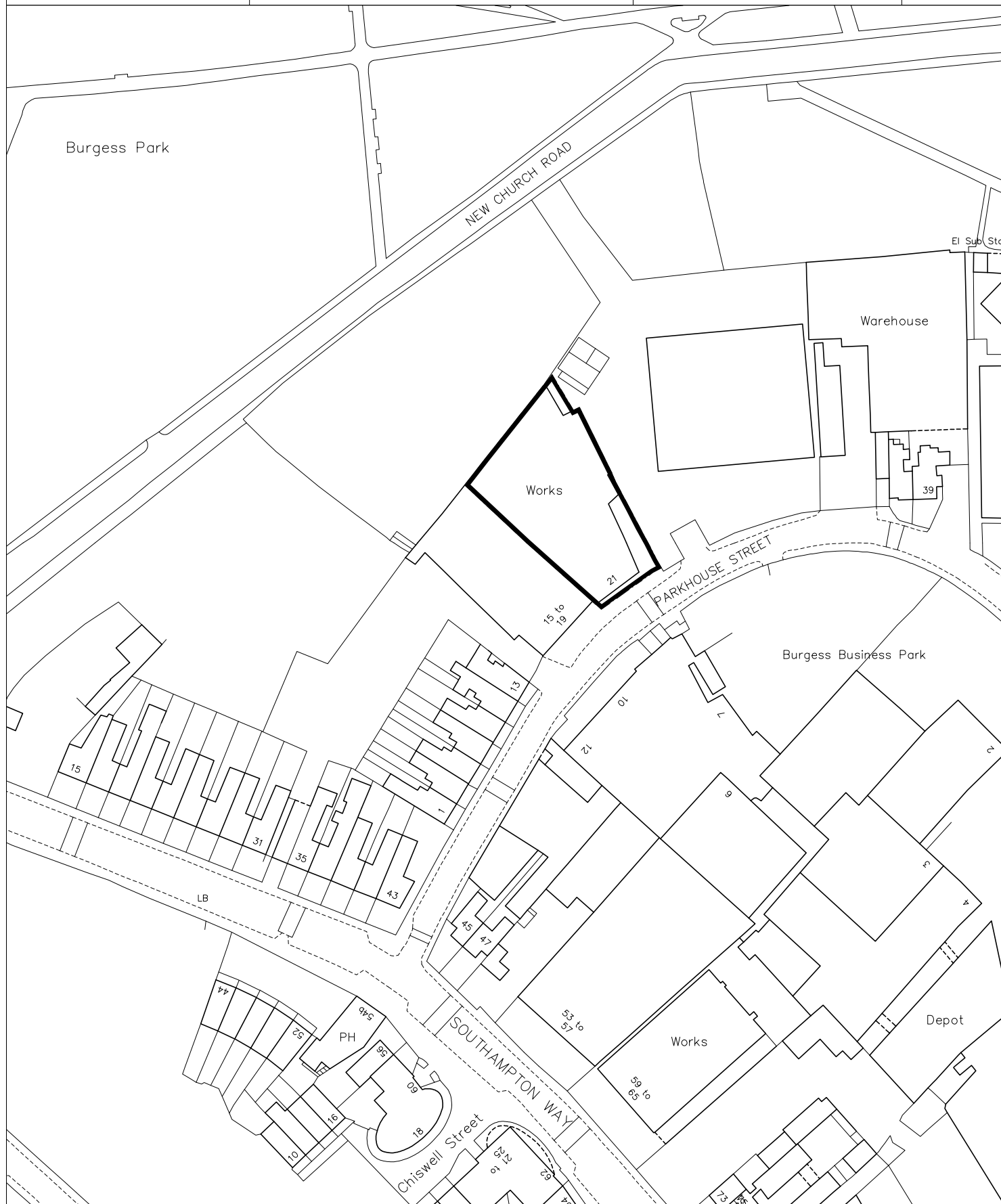
Original Scale - 1:1250Subject to variation when reproduced
from an Adobe pdf source



TITLE.

Angel Oak Academy.

APPENDIX 6

APPROPRIATION EXTENT

DRAWING No. LBS_3294(Layout2)

DRAWN BY. MMANKTELOW
Property Division

DATE. 7/2/2017

Reproduced from the Ordnance Survey mapping with the permission of the Controller of Her Majesty's Stationery Office © Crown copyright. Unauthorised reproduction infringes Crown copyright and may lead to prosecution or civil proceedings. (London Borough of Southwark / Licence No. LA086541).

Original Scale - 1:1250

Subject to variation when reproduced
from an Adobe pdf source

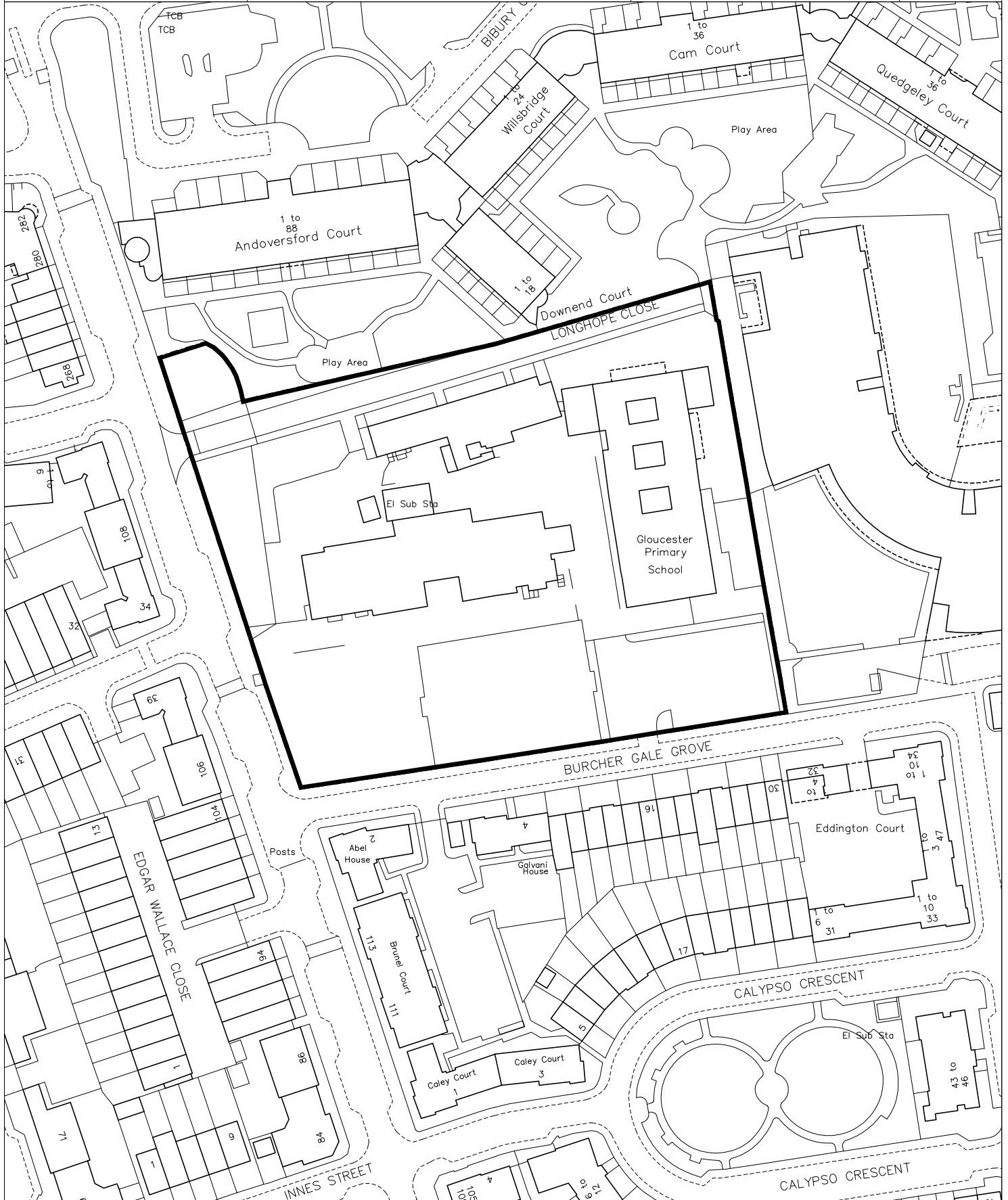

TITLE.

Wyndham Road & Redcar Street. APPROPRIATION EXTENT



DRAWING No. LBS_3246(Layout2)

DRAWN BY. MMANKTELOW
Property Division

DATE. 18/1/2017

Reproduced from the Ordnance Survey mapping with the permission of the Controller of Her Majesty's Stationery Office © Crown copyright. Unauthorised reproduction infringes Crown copyright and may lead to prosecution or civil proceedings. (London Borough of Southwark / Licence No. LA086541).

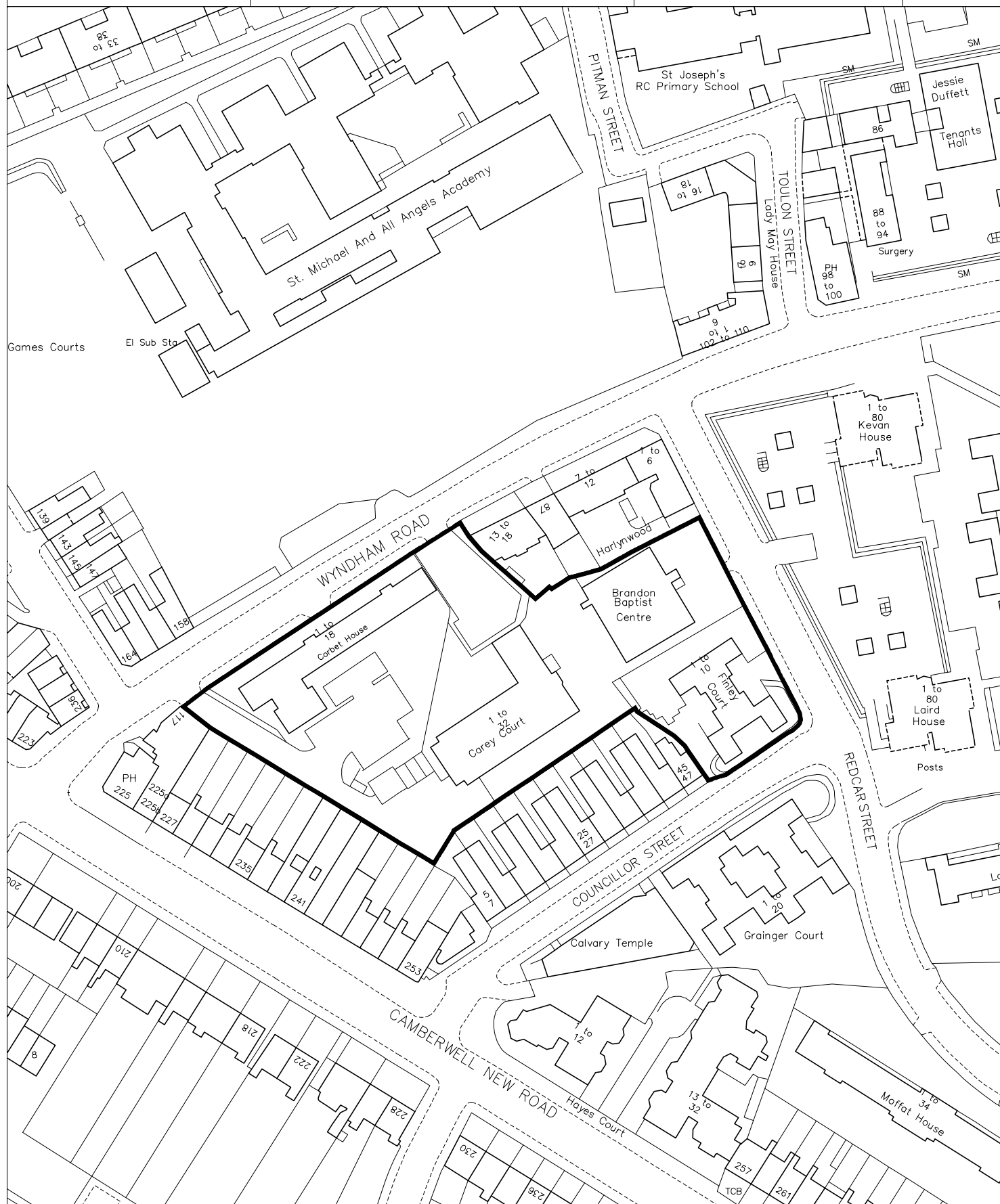
Original Scale - 1:1250Subject to variation when reproduced
from an Adobe pdf source



TITLE.

Sumner House,
Sumner Road, SE15.

APPENDIX 8
APPROPRIATION EXTENT

DRAWING No. LBS_3261(Layout2)

Reproduced from the Ordnance Survey mapping with the permission of the Controller of Her Majesty's Stationery Office © Crown copyright. Unauthorised reproduction infringes Crown copyright and may lead to prosecution or civil proceedings. (London Borough of Southwark / Licence No. LA086541).

DRAWN BY. MMANKTELOW
Property Division

Original Scale - 1:1250

DATE. 18/1/2017

Subject to variation when reproduced
from an Adobe pdf source

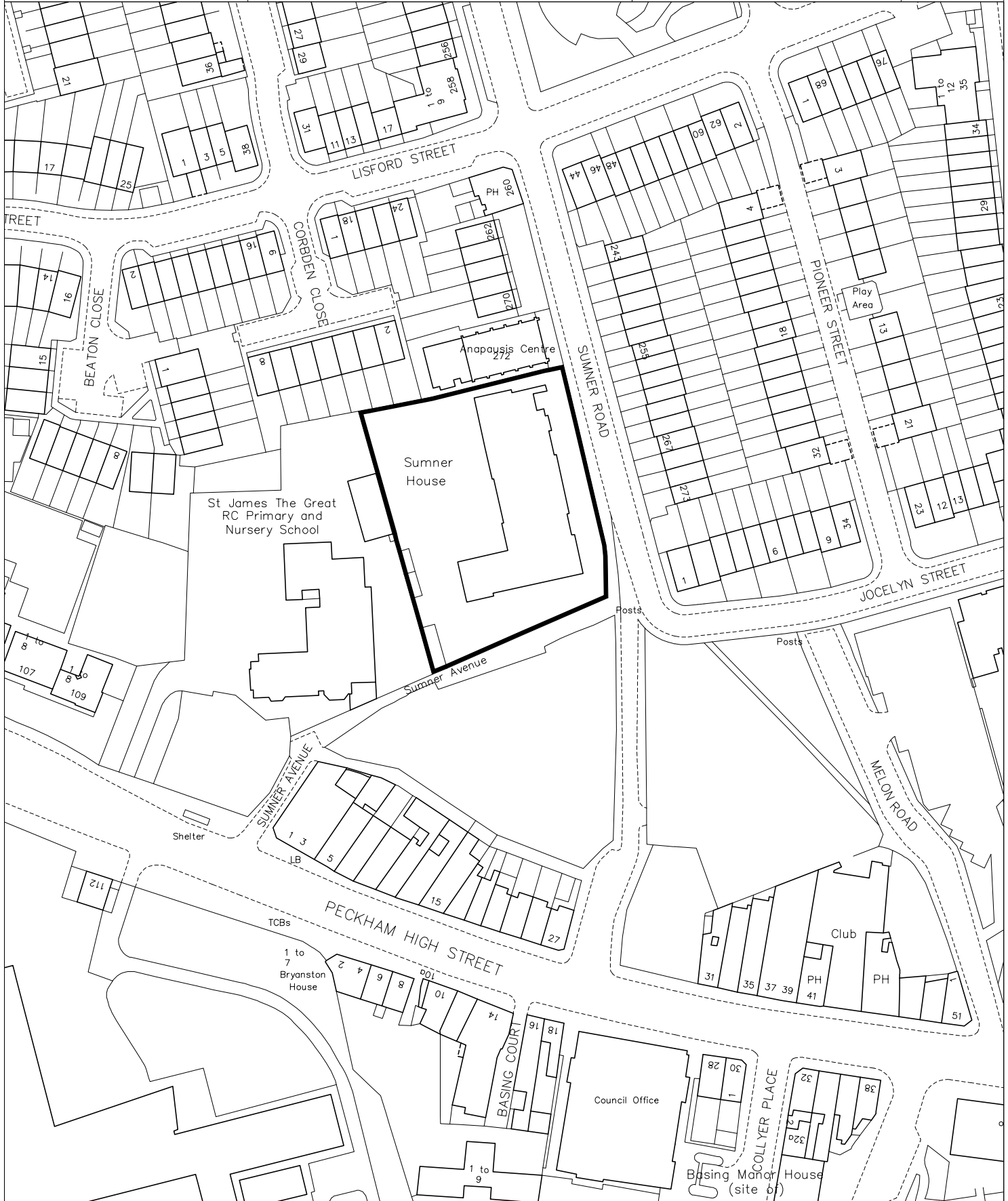



TITLE.

Fred Francis,
Lordship Lane, SE22 8JG.

APPENDIX 9

APPROPRIATION EXTENT

DRAWING No. LBS_3242(Layout2)

DRAWN BY. MMANKTELOW
Property Division

DATE. 18/1/2017

Reproduced from the Ordnance Survey mapping with the permission of the Controller of Her Majesty's Stationery Office © Crown copyright. Unauthorised reproduction infringes Crown copyright and may lead to prosecution or civil proceedings. (London Borough of Southwark / Licence No. LA086541).

Original Scale - 1:1250

Subject to variation when reproduced
from an Adobe pdf source

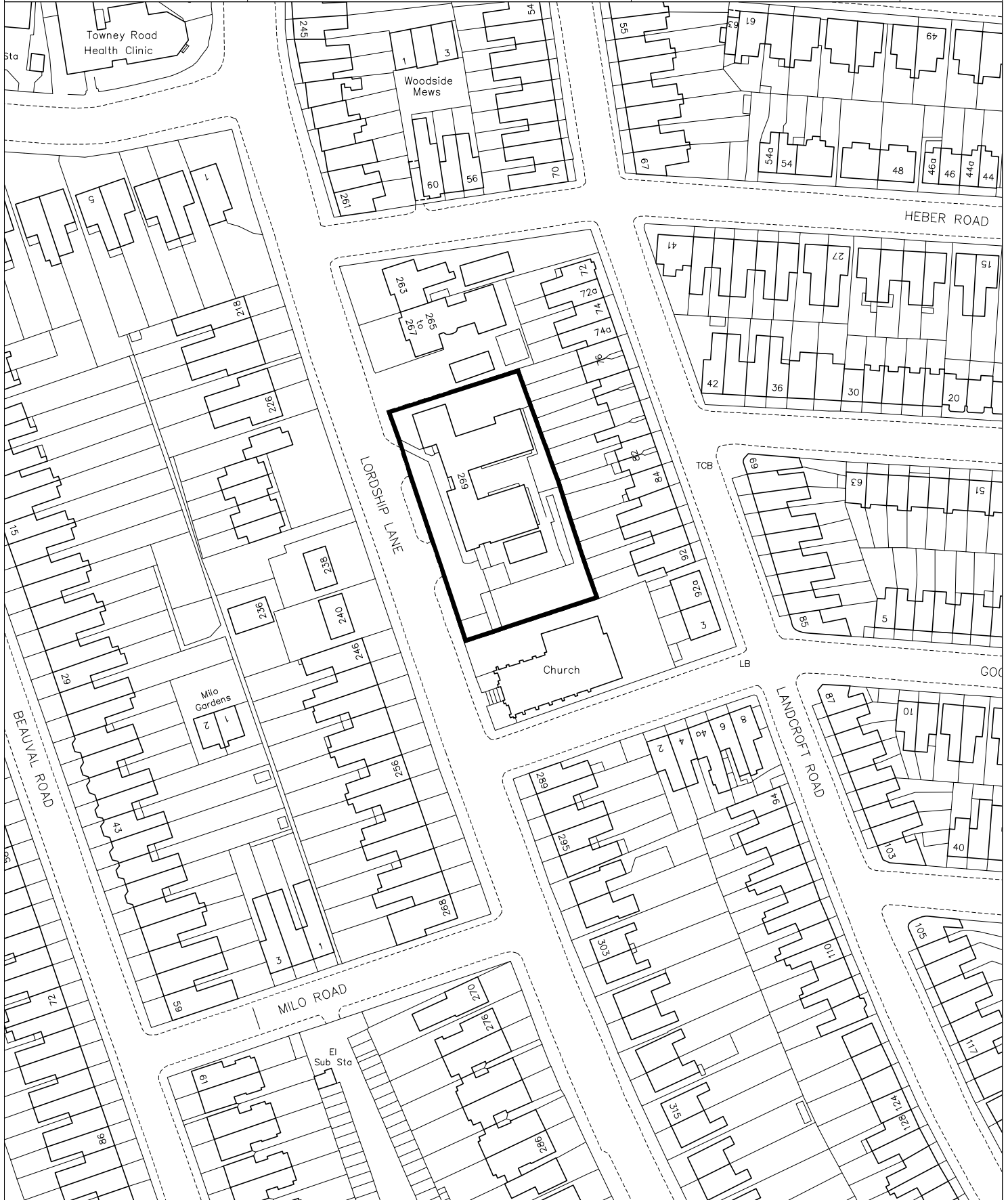



TITLE.

Wickway Community Centre,
Cator Street / St. George's Way, SE15.

APPENDIX 10
APPROPRIATION EXTENT

DRAWING No. LBS_3245(Layout2)

DRAWN BY. MMANKTELOW
Property Division

DATE. 18/1/2017

Reproduced from the Ordnance Survey mapping with the permission of the Controller of Her Majesty's Stationery Office © Crown copyright. Unauthorised reproduction infringes Crown copyright and may lead to prosecution or civil proceedings. (London Borough of Southwark / Licence No. LA086541).

Original Scale - 1:1250

Subject to variation when reproduced
from an Adobe pdf source



NEATE STREET

ST GEORGE'S WAY

Community Centre

EBLEY CLOSE

LB

Quedgeley Court

Westonbirt Court

Quenington Court

CATOR STREET

Wickway Court
1 to 118

31 to 41

Alder House